

ANNUAL REPORT FOR 2025

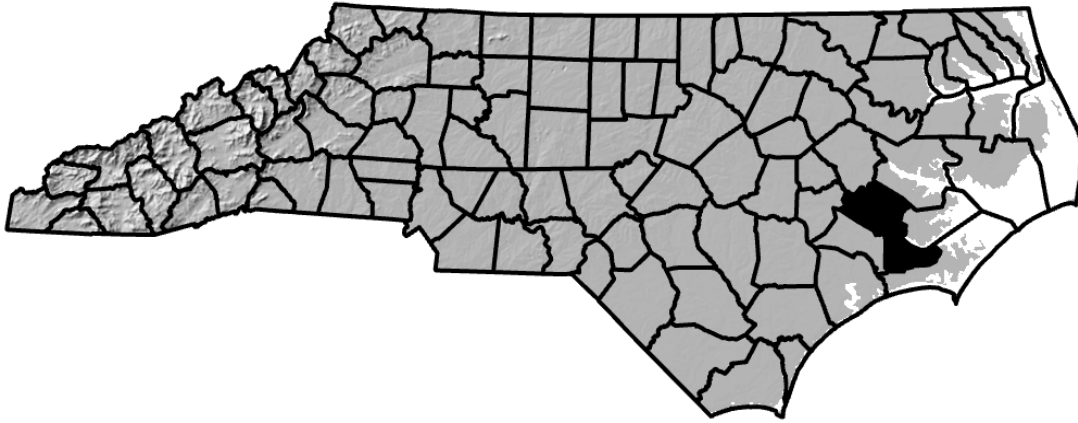

**Adams Creek Road over Club Foot Creek Temporary Impact Site
Craven County**

Project #: BP2.R020

COE Action ID: SAW-202201492

DWR Project #: 20220355

CAMA Permit #: 108-22



Prepared By:
Roadside Environmental Unit and Environmental Analysis Unit
North Carolina Department of Transportation
August 2025

TABLE OF CONTENTS

SUMMARY	1
1.0 Introduction	2
.1 Project Description	2
.2 Purpose	2
.3 Project History	2
.4 Debit Ledger.....	2
2.0 Vegetation:	3
.1 Success Criteria	3
.2 Description of Species.....	3
.3 Results of Vegetation Monitoring	3
.4 Conclusions.	4
3.0 Overall Conclusions and Recommendations	4

FIGURES

Figure 1 – Vicinity Map	5
-------------------------------	---

APPENDICES

Appendix A – Site Photos and Site Maps

SUMMARY

The Adams Creek Road over Club Foot Creek Temporary Impact Site is located in Craven County, hereafter referred to as Club Foot Creek. This is an annual report for temporary impacts associated with Project No. BP2.R020 culvert replacement at Adams Creek Road over Club Foot Creek. Project was completed in November 2023.

The temporary impacts encompass approximately 6,315 square feet due to hand clearing within Coastal wetlands. The area that was impacted is being monitored for three years to ensure that it re-attains wetland jurisdictional status.

After the second year of monitoring, the Club Foot Creek Temporary Impact Site shows by visual observation that the temporarily impacted areas have re-attained jurisdictional wetland status.

NCDOT proposes to discontinue monitoring at the Club Foot Creek Temporary Impact Site.

1.0 INTRODUCTION

1.1 Project Description

The Club Foot Creek Temporary Impact Site is located in Craven County (Figure 1). The temporary impacts encompass approximately 6,315 square feet due to hand clearing within Coastal wetlands. The area that was impacted is being monitored for three years to ensure that it re-attains wetland jurisdictional status.

1.2 Purpose

In order for a temporary impact site to be considered successful, a site must meet the success criteria. This report details the monitoring in 2025 at the Club Foot Creek Temporary Impact Site.

1.3 Project History

November 2023	Project Completion
September 2024	Vegetation Monitoring (Year 1)
August 2025	Vegetation Monitoring (Year 2)

1.4 Debit Ledger

The restoration of the Club Foot Creek Temporary Impact Site was used entirely to compensate for temporary impacts on the BP2.R020 project. There were no wetland mitigation credits generated from the restoration of the temporary impacted area.

2.0 VEGETATION: ADAM CREEK ROAD OVER CLUB FOOT CREEK TEMPORARY IMPACT SITE (YEAR 2 MONITORING)

2.1 Success Criteria

Condition 28: Due to the possibility that compaction, hand clearing, and/or other site alterations might prevent the temporary Coastal Wetland impact areas from re-attaining pre-project wetland functions, the permittee shall provide annual update on the Coastal Wetland areas temporarily impacted by this project. This annual update shall consist of photographs and a brief written report on the progress of these temporarily impacted areas in re-attaining their pre-project wetland functions. The permittee shall schedule a meeting with DCM to verify the extent and location of temporary impacts upon project completion. Within three after project completion, the permittee shall hold another agency field meeting with DCM to determine if the Coastal Wetland areas temporarily impacted by this project have re-attained pre-project wetland functions. If at the end of three years DCM determines that the Coastal Wetland areas temporarily impacted by the project have not re-attained pre-project wetland functions, DCM will determine whether compensatory wetland mitigation shall be required.

2.2 Description of Species

The following wetland species were planted in the temporary impact area:

No species were planted. Temporary Coastal wetland impacted areas were left to revegetate naturally.

2.3 Results of Vegetation Monitoring

The impacted area where the temporary impacts occurred has re-attained jurisdictional wetland status. Other species noted within the temporary Coastal wetland impact area included big cordgrass, cattail, black needle rush, salt meadow cordgrass, fern, baldcypress, baccharis, and various grasses.

2.4 Conclusions

There were approximately 6,315 square feet due to hand clearing within Coastal wetlands. There were no plots established on the site. By visual observation, the Club Foot Creek Temporary Impact Site shows that the impacted areas have re-attained jurisdictional wetland status. The temporary impact area has re-vegetated with wetland species.

3.0 OVERALL CONCLUSIONS AND RECOMMENDATIONS

NCDOT proposes to discontinue monitoring at the Club Foot Creek Temporary Impact Site.

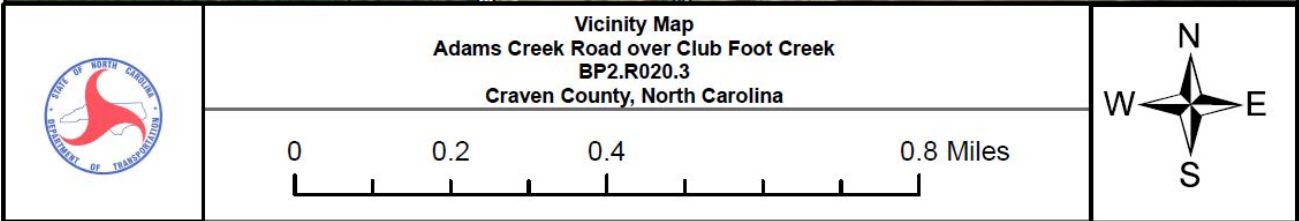
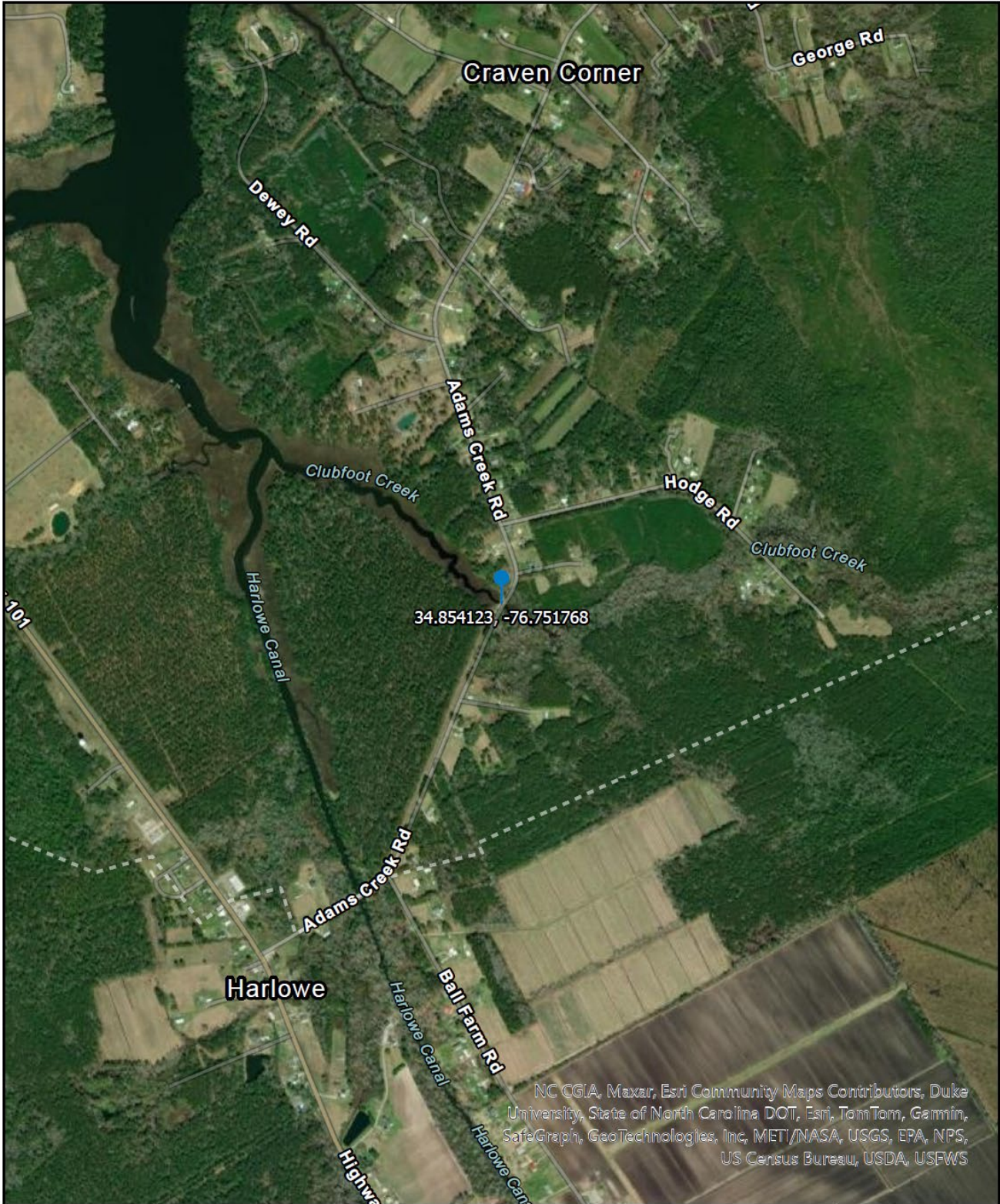

Figure 1. Vicinity Map

APPENDIX A

SITE PHOTOS & SITE MAPS

Club Foot Creek Temporary Impact Site



PP#1



PP#2



PP#3



PP#4



PP#5
August 2025



PP#6

Club Foot Creek Temporary Impact Site



PP#7





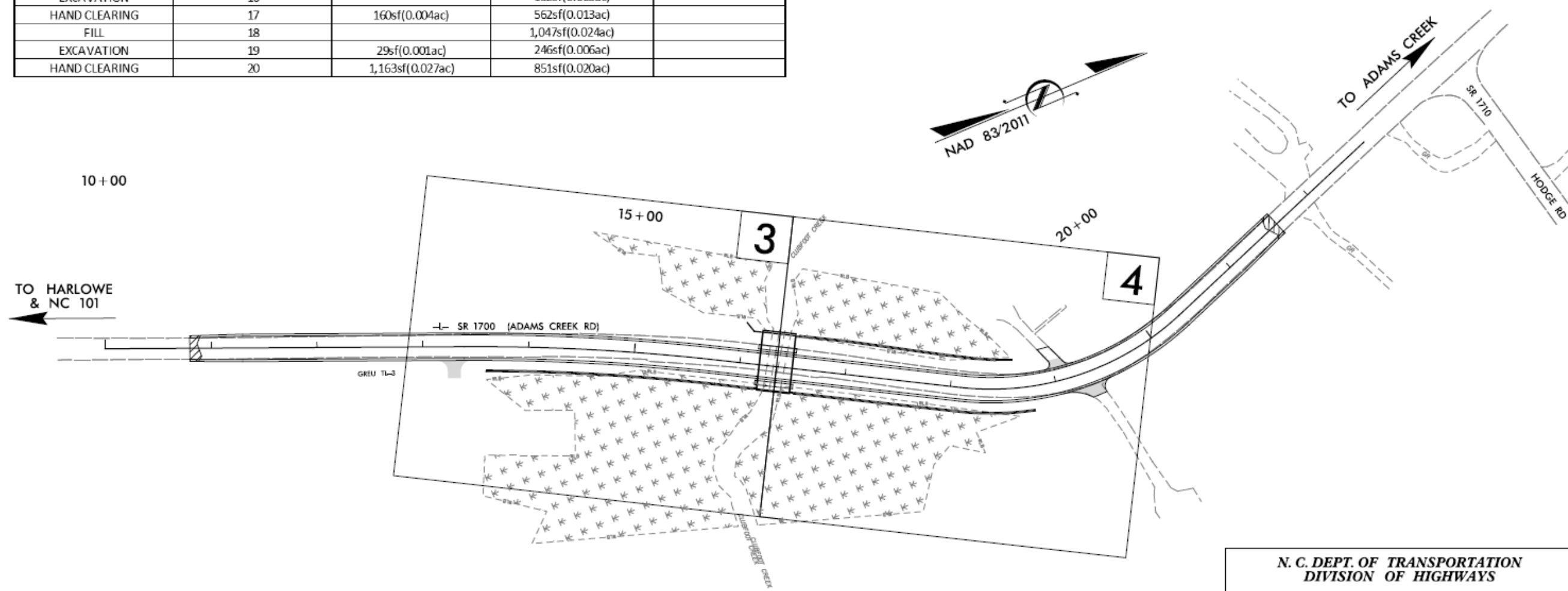

PROPOSED IMPACTS TO JURISDICTIONAL WETLANDS AND SURFACE WATERS				
FEATURE NAME	SITE NUMBER	IMPACT		
		CWA SECTION 404 WETLAND (ESTUARINE WOODY WETLAND)	COASTAL WETLAND (SALT/BRACKISH MARSH)	SURFACE WATER (CLUBFOOT CREEK)
HAND CLEARING	1		60sf(0.001ac)	
FILL	2	508sf(0.012ac)	354sf(0.008ac)	
HAND CLEARING	3	226sf(0.005ac)	325sf(0.008ac)	
EXCAVATION	4		84sf(0.002ac)	
TEMP. STREAM IMPACT	5			15 linear feet
HAND CLEARING	6	28sf(0.001ac)	1,729sf(0.040ac)	
FILL	7		44sf(0.001ac)	
FILL IN SURFACE WATER	8			6sf(0.0001ac)
EXCAVATION	9		61sf(0.001ac)	
TEMP. STREAM IMPACT	10			15 linear feet
EXCAVATION	11		39sf(0.001ac)	
FILL IN SURFACE WATER	12			5sf(0.0001ac)
HAND CLEARING	13		676sf(0.016ac)	
FILL	14		765sf(0.018ac)	
HAND CLEARING	15	244sf(0.006ac)	2,112sf(0.049ac)	
EXCAVATION	16		132sf(0.003ac)	
HAND CLEARING	17	160sf(0.004ac)	562sf(0.013ac)	
FILL	18		1,047sf(0.024ac)	
EXCAVATION	19	29sf(0.001ac)	246sf(0.006ac)	
HAND CLEARING	20	1,163sf(0.027ac)	851sf(0.020ac)	

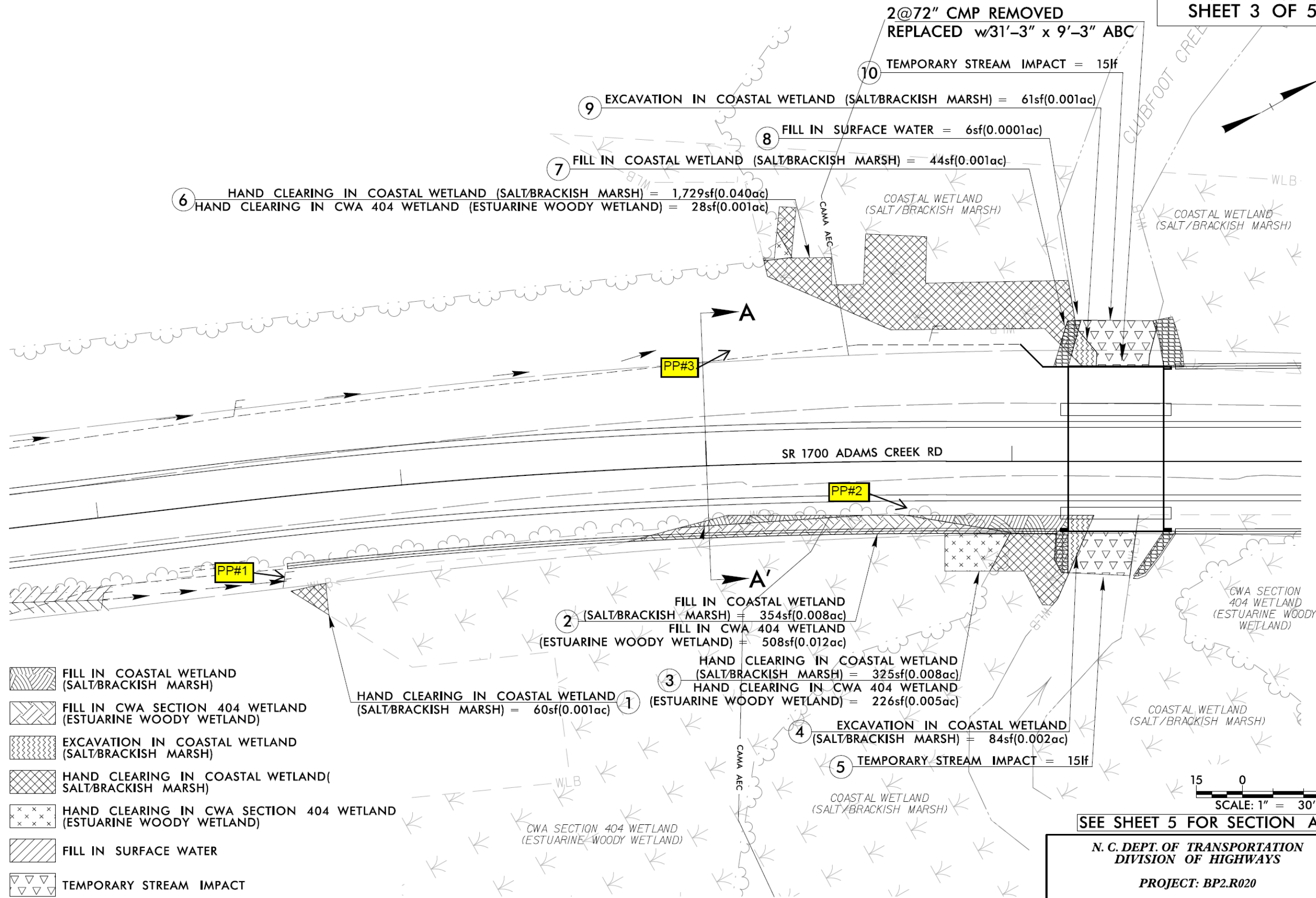
PERMANENT COASTAL WETLAND (SALT/BRACKISH MARSH) FILL	2,210sf(0.051ac)
PERMANENT COASTAL WETLAND (SALT/BRACKISH MARSH) EXCAVATION	562sf(0.013ac)
TOTAL PERMANENT COASTAL WETLAND IMPACTS	2,772sf(0.064ac)
PERMANENT CWA SECTION 404 WETLAND (ESTUARINE WOODY WETLAND) FILL	508sf(0.012ac)
PERMANENT CWA SECTION 404 WETLAND (ESTUARINE WOODY WETLAND) EXCAVATION	29sf(0.001ac)
TOTAL PERMANENT CWA SECTION 404 WETLAND IMPACTS	537sf(0.012ac)
TOTAL PERMANENT WETLAND FILL	2,719sf(0.062ac)
TOTAL PERMANENT WETLAND EXCAVATION	591sf(0.014ac)
TOTAL COMBINED WETLAND IMPACTS	3,310sf(0.076ac)
TEMPORARY COASTAL WETLAND (SALT/BRACKISH MARSH) IMPACT FROM HAND CLEARING	6,315sf(0.145ac)
TEMPORARY CWA SECTION 404 WETLAND (ESTUARINE WOODY WETLAND) IMPACT FROM HAND CLEARING	1,821sf(0.042ac)
TOTAL TEMPORARY WETLAND IMPACT - HAND CLEARING	8,136sf(0.187ac)
TOTAL PERMANENT FILL IN SURFACE WATERS (CLUBFOOT CREEK)	11sf(0.0003ac)
TOTAL TEMPORARY IMPACT TO STREAMS (CLUBFOOT CREEK)	30 linear feet



N. C. DEPT. OF TRANSPORTATION
DIVISION OF HIGHWAYS
PROJECT: BP2.R020
CULVERT ON SR 1700 (ADAMS CREEK RD)
OVER CLUBFOOT CREEK
MAY 2022



-  FILL IN COASTAL WETLAND (SALT/BRACKISH MARSH)
-  FILL IN CWA SECTION 404 WETLAND (ESTUARINE WOODY WETLAND)
-  EXCAVATION IN COASTAL WETLAND (SALT/BRACKISH MARSH)
-  HAND CLEARING IN COASTAL WETLAND (SALT/BRACKISH MARSH)
-  HAND CLEARING IN CWA SECTION 404 WETLAND (ESTUARINE WOODY WETLAND)
-  FILL IN SURFACE WATER
-  TEMPORARY STREAM IMPACT

15 0 30
SCALE: 1" = 30'

SEE SHEET 5 FOR SECTION A-A'

N. C. DEPT. OF TRANSPORTATION
DIVISION OF HIGHWAYS
PROJECT: BP2.R020
CULVERT ON SR 1700 (ADAMS CREEK RD)
OVER CLUBFOOT CREEK
MAY 2022

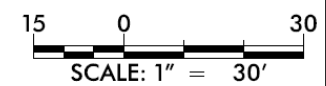
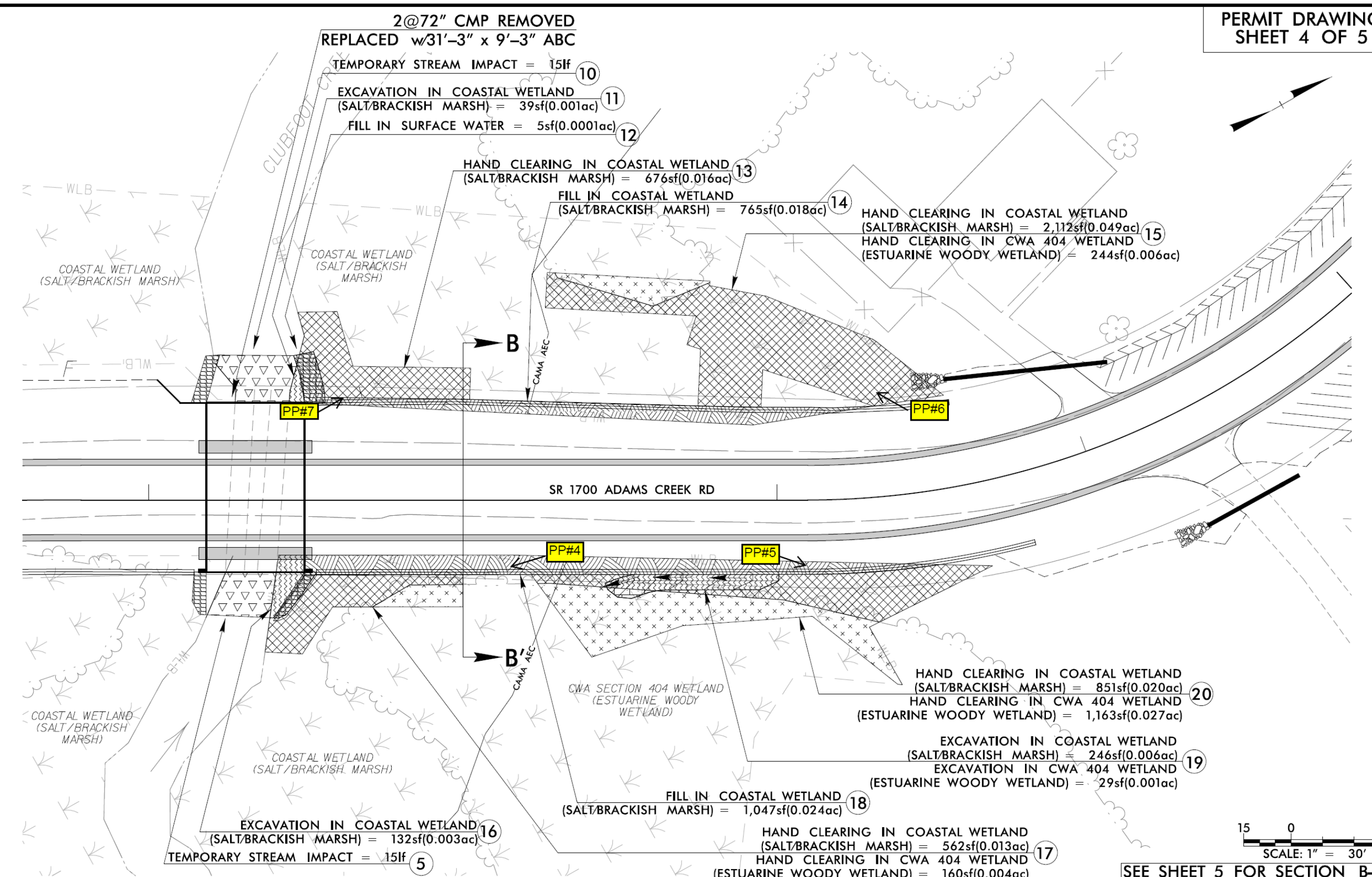

SEE SHEET 5 FOR SECTION B-B'

N. C. DEPT. OF TRANSPORTATION
DIVISION OF HIGHWAYS
PROJECT: BP2.R020
CULVERT ON SR 1700 (ADAMS CREEK RD)
OVER CLUBFOOT CREEK
MAY 2022

- | | | |
|---|--|-------------------------|
| FILL IN COASTAL WETLAND (SALT/BRACKISH MARSH) | EXCAVATION IN CWA SECTION 404 WETLAND (ESTUARINE WOODY WETLAND) | FILL IN SURFACE WATER |
| FILL IN CWA SECTION 404 WETLAND (ESTUARINE WOODY WETLAND) | HAND CLEARING IN COASTAL WETLAND (SALT/BRACKISH MARSH) | TEMPORARY STREAM IMPACT |
| EXCAVATION IN COASTAL WETLAND (SALT/BRACKISH MARSH) | HAND CLEARING IN CWA SECTION 404 WETLAND (ESTUARINE WOODY WETLAND) | |